



www.FleetwoodRV.com

**38W** Options: 099, 107, 189, 209, 217, 237, 345, 473, 563, 830

**TOP FLOORPLAN FEATURES**

- Sleeps up to 7
- Large Master Suite
- Sofa w/Sleeper
- 49" Pop-up LED TV, Living Room
- Dual Wardrobes and Dresser, Bedroom
- Large Residential-like, Private Lavy with His and Her Dual Sinks
- Pantry

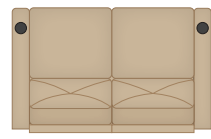
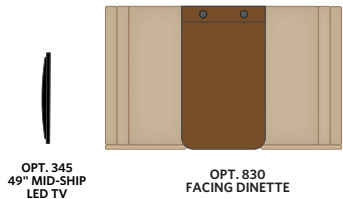
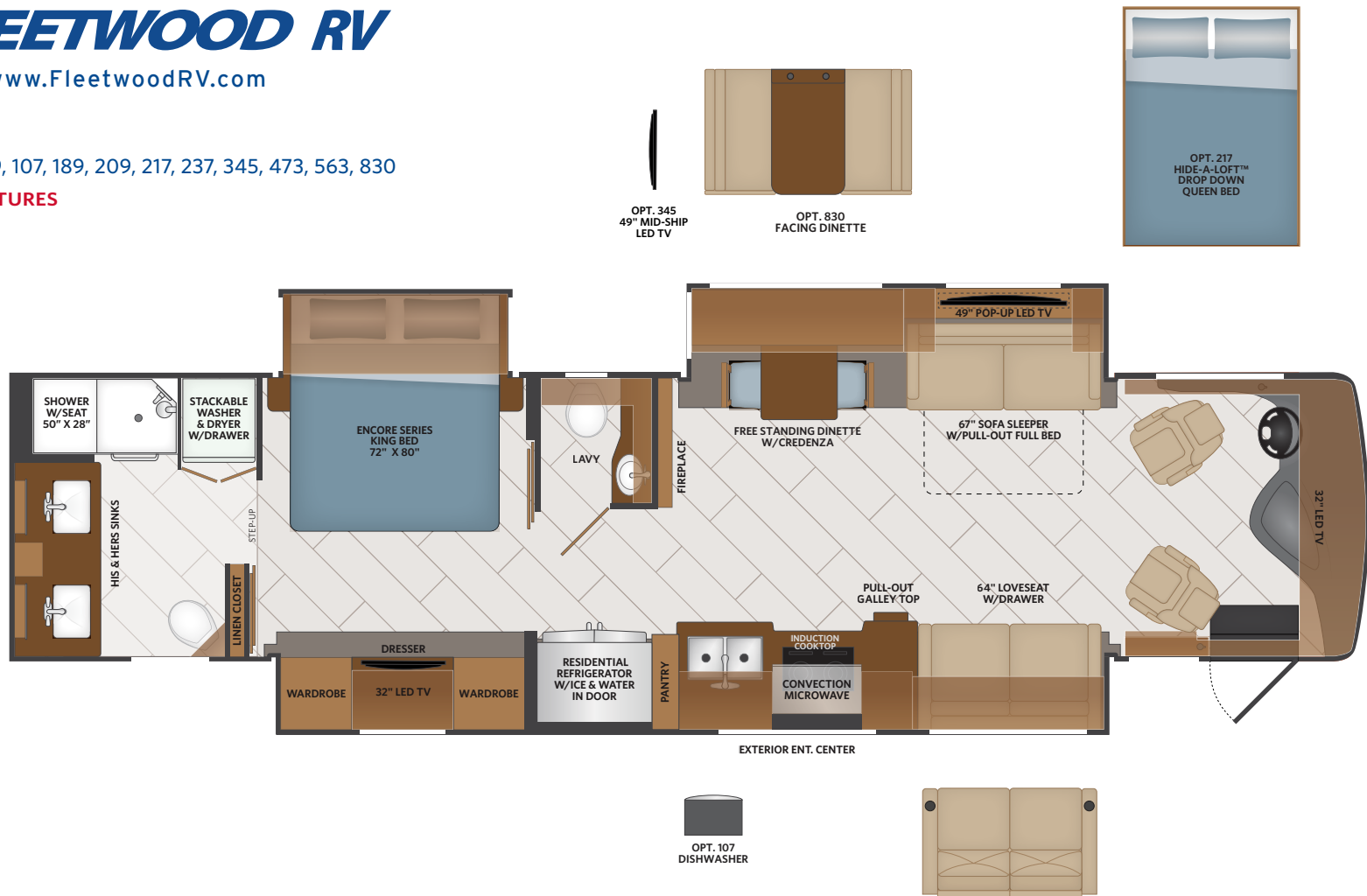

DISCOVERY OPTIONS

099	Satellite Delete	473	Brakesync—NEW
107	Dishwasher	563	Technology Package: WiFiRanger™ SkyPro w/LTE and GPS, Cell Booster, 265W Solar Panel, Upgraded Kenwood® Radio, and MobileEye Collision Mitigation Camera
189	Power Passenger Seat w/Power Footrest	634	U-shaped Dinette
209	Motion Power Lounge (Ottoman's are omitted on 44B)	809	L-shaped Dinette
217	Hide-A-Loft™ Drop Down Queen Bed	830	Facing Dinette
237	Third Roof A/C	833	Free Standing Dinette w/Credenza
345	Mid-ship LED TV		

OPT. 209 MOTION POWER LOUNGE

**FREEDOM BRIDGE® CHASSIS**

Model: Freightliner® XCM Series  
 Engine: Cummins ISB 6.7L  
 Transmission: Allison® 3,000 MH 6-Speed w/Electronic Shifter  
 Alternator: Delcom Remy 160 Amp  
 Torque: 800 lb.-ft. @ 1,800 RPM  
 Horsepower: 360HP



FLOORPLAN **38W** 2022 CLASS A DIESEL **DISCOVERY**