



www.FleetwoodRV.com

**36DB** Options: 096, 105, 126, 131, 194, 230, 470, 471, 580, 605, 953

**TOP FLOORPLAN FEATURES**

- Sleeps up to 8
- Bunk Beds 28"x75" with Sliding Barn Doors
- C-PAP Storage in Master Bedroom
- IllumaPlex Control System w/App.
- Power Ceiling Vents
- Generous Wardrobe and Dresser Bedroom Storage
- Mid Lavy includes Tub/Shower with Enclosure
- 26,000# Chassis

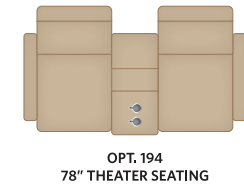
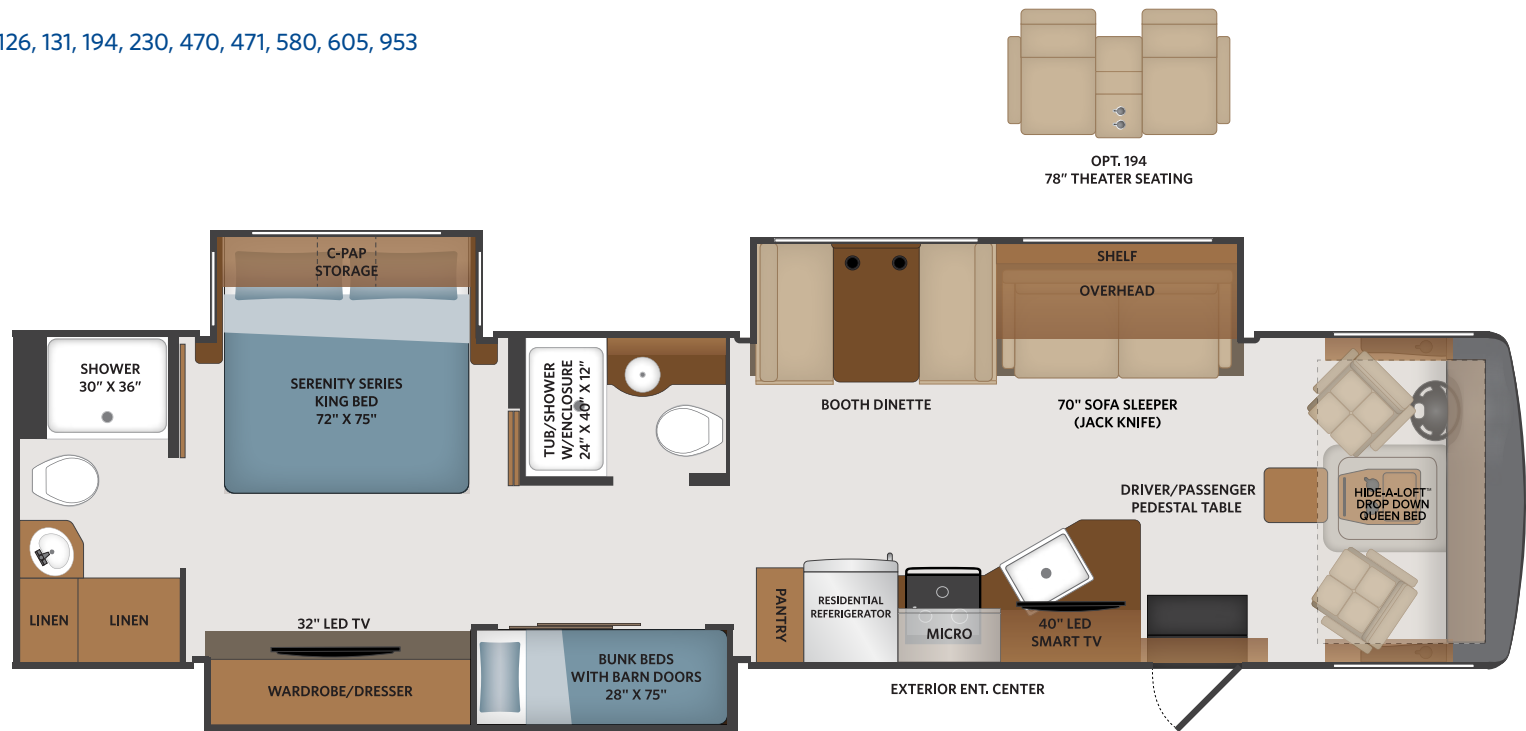

**FORD® CHASSIS**

Model: Ford®  
 Engine: 7.3L Triton V8  
 Transmission: Ford® 6-Speed, Automatic w/Overdrive  
 Alternator: 175 Amp  
 Torque: 468 lb.-ft. @ 3,000 RPM  
 Horsepower: 350HP @ 3,900 RPM



FORTIS  
OPTIONS

096	KING® Universal Satellite System	194	Theater Seating	580	Collision Mitigation
105	Dometic 8CF Double Door Refrigerator - LP	230	Roof Vent Rain Covers	605	Dual Glazed Windows
126	Washer/Dryer — All in one combo	470	SumoSprings® - Front/Rear	953	Power Driver Seat
131	Washer/Dryer — Stackable	471	Steering Stabilizer System		

FLOORPLAN **36DB**

20 | CLASS A GAS  
22 | **FORTIS**